

898 12 Gun Slanted Base Cabinet

Components List:

Upper Cabinet

- A. Top Panel1pc
- B. Upper Barrel Rest.....1pc
- C. Upper Back Panel.....1pc
- D. Upper Left Side Panel.....1pc
- E. Upper Right Side Panel with Hinges.....1pc
- F. Upper Door Frame.....1pc
- G. Drawer Top Panel.....1pc
- H. Lower Barrel Rest.....1pc

Upper Cabinet

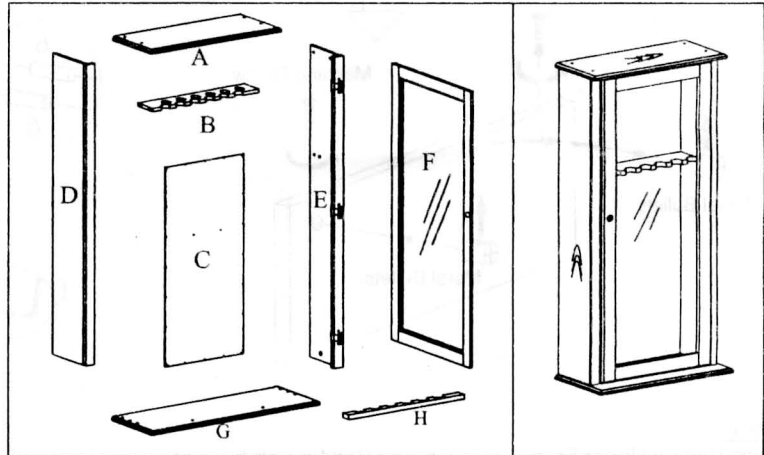

Lower Cabinet

- I. Bottom Door Frame with Lock.....1pc
- J. Bottom Back Panel1pc
- K. Bottom Front Rail with Hinges..... 1pc
- L. Bottom Frame1pc
- M. Bottom Left Side Panel1pc
- N. Bottom Right Side Panel1pc
- O. Bottom Upper Front Rail.....1pc
- P. Bottom Shelf.1pc
- Q. Bottom Middle Front Rail with Hinges.....1pc
- R. Middle Slanted Door Frame..... 1pc

Lower Cabinet

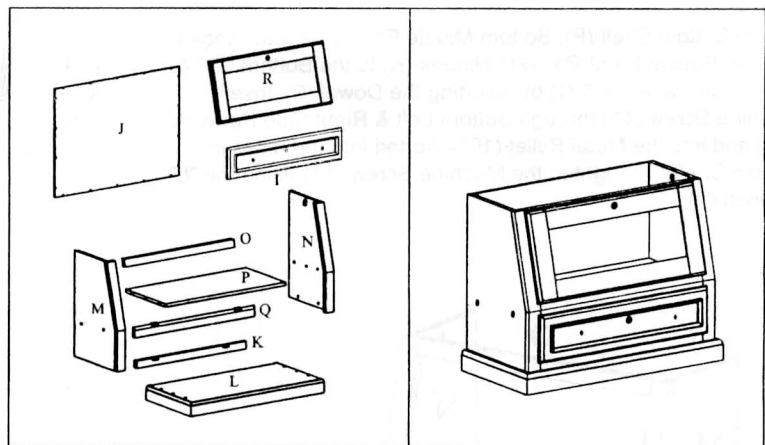

Hardware List:

- 1. "L"Wrench1pc
- 2. Threaded Pin.....2pcs
- 3. Arch Nut.....2pcs
- 4. Round Head Wood Screw39pcs
- 5. Flat Head Hinge Screw17 pcs
- 6. Dowel.....32pcs
- 7. Drawer Knob.2pcs
- 8. Knob Screw2pcs
- 9. Door Spacer Block.....1pc
- 10. Metal Bullet.....14pcs
- 11. Machine Screw12pcs
- 12. Wrench.....1pc
- 13. Wood Plug.....4pcs
- 14. Door Support.....1pc
- 15. Keys.....3pairs
- 16. Levelers.....4 pcs

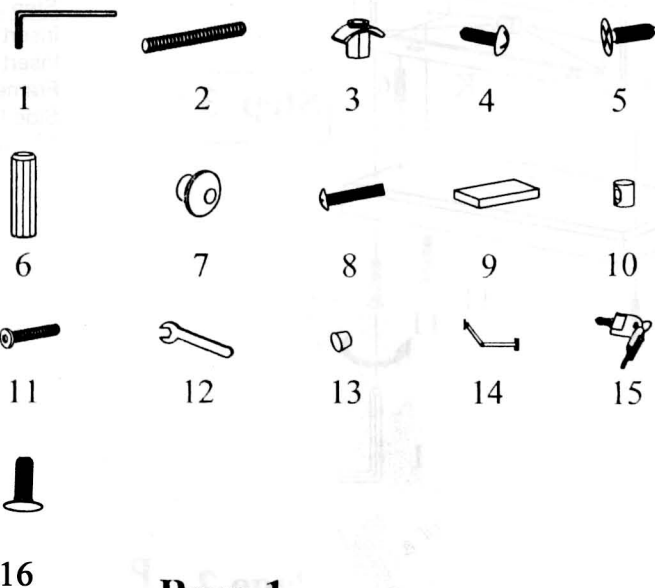

Assembly Instructions: 898 12 Gun Slanted Base Cabinet

Unpack carton on a clean, smooth surface and inventory parts.

Important: Always Insert Metal Bullets so that the X in the end of the Bullet faces out of the holes and that the Threaded Hole is turned vertically for alignment with Machine Screws.

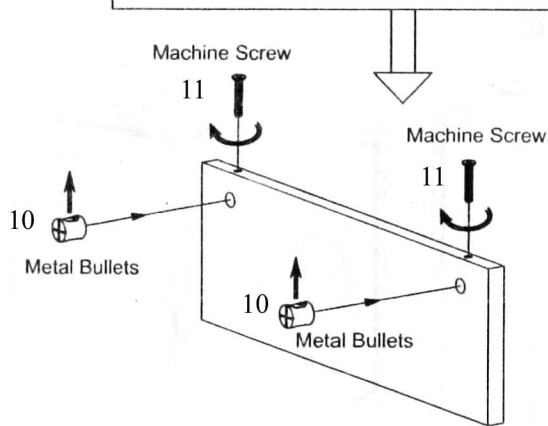

Step 1

Step 1:
Attach Bottom Upper Front Rail (O) to the Bottom Left & Right Side Panel (M & N) by inserting Dowel (6).

Step 2:
Attach Bottom Shelf (P), Bottom Middle Front Rail with Hinges (Q) and Bottom Front Rail with Hinges (K) to the Bottom Left & Right Side Panel (M & N) by inserting the Dowel (6). Insert Machine Screw (11) through Bottom Left & Right Side Panel (M & N) and into the Metal Bullet (10) inserted into the holes in Bottom Shelf (P). Tighten the Machine Screw (11) using the "L" Wrench (1).

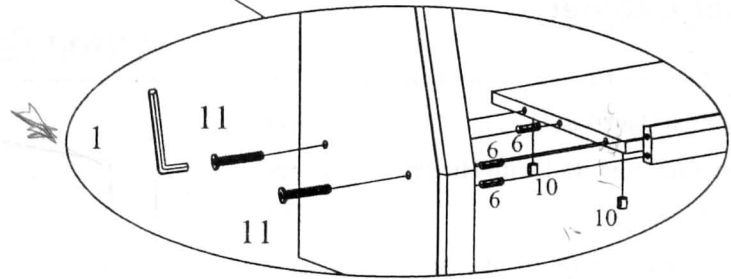

Step 2

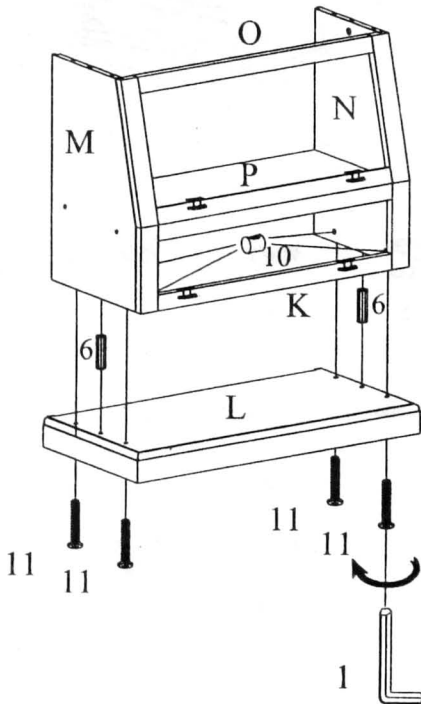

Step 3

Step 3:
Insert the Dowel (6) into the holes in the Bottom Frame (L). Insert the Machine Screw (11) through the bottom of the Bottom Frame (L) and into the Metal Bullet (10) inserted into the Bottom Side Panel (M & N). Tighten the Machine Screw (11) using the "L" Wrench (1).

Assembly Instructions: 898 12 Gun Slanted Base Cabinet

Step 4:

Attach Upper Barrel Rest (B) to Upper Left Side Panel and Right Side Panel with Hinges (D & E) by inserting Dowel (6) into the holes.

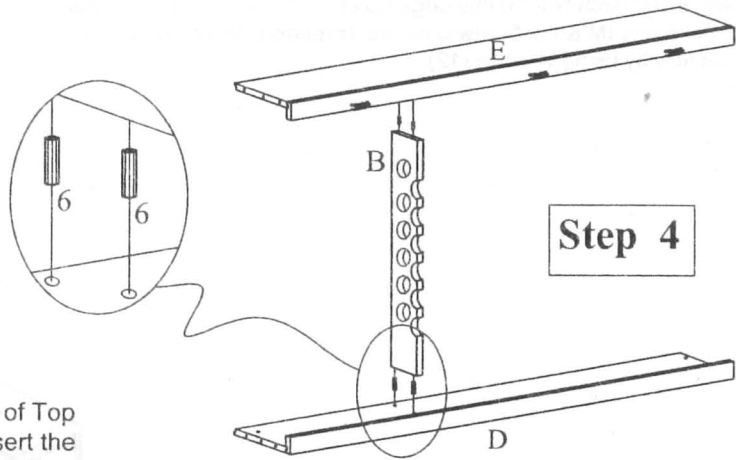

Step 5:

Insert the Dowel (6) into the holes on the bottom side of Top Panel (A) and into the Upper Side Panels (D & E). Insert the Machine Screw (11) through the Top Panel (A) and into the Metal Bullet (10) inserted into the Upper Side Panels (D & E). Tighten the Machine Screw (11) using "L" Wrench (1).

Step 6:

Insert the Dowel (6) into the holes on the top of Drawer Top Panel (G) and into the Upper Side Panels (D & E). Insert the Threaded Pin (2) through the bottom of Drawer Top Panel (G) and into the Metal Bullet (10) inserted into the Upper Side Panels (D & E). Tighten the Threaded Pin (2) by hand until it stops. **DO NOT OVER TIGHTEN!**

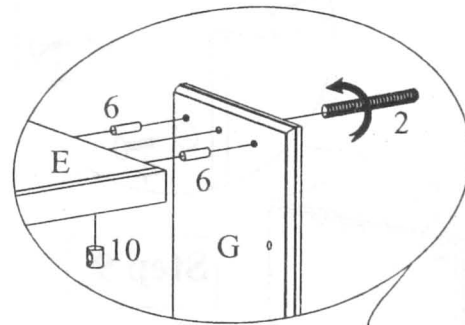
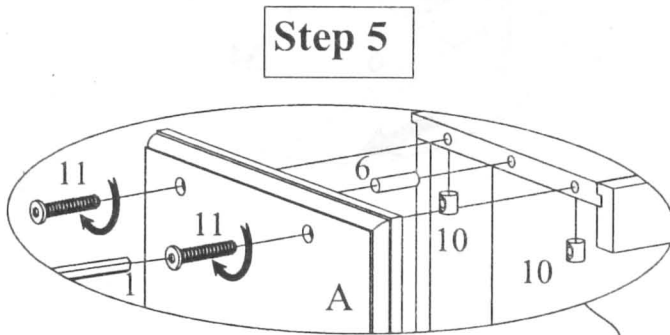

Step 7:

Attach the Lower Barrel Rest (H) to the Drawer Top Panel (G) by inserting Dowel (6).

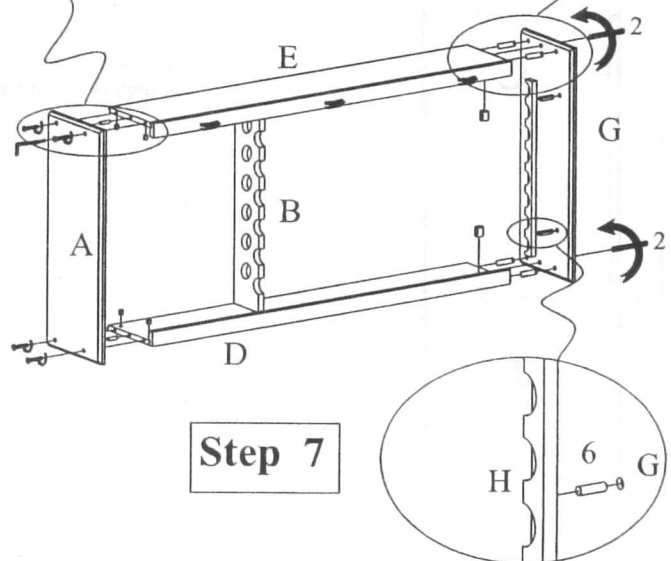

Assembly Instructions: 898 12 Gun Slanted Base Cabinet

Step 8:

Lay both the Upper and Lower Cabinets on their back on the floor. Slide the Upper and Lower Cabinets together making sure that the Dowel (6) and the Threaded Pin (2) align properly with the holes in the Lower Cabinet Side Panels. Insert Arch Nut (3) into large holes on the inside of the Lower Cabinet Sides (M & N). Screw onto the Threaded Pin (2) by hand then tighten fully by using Wrench (12).

Step 8

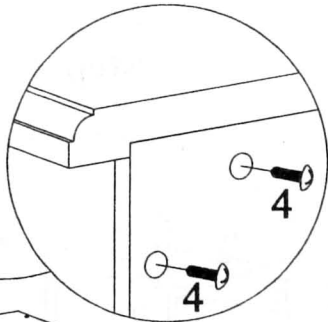
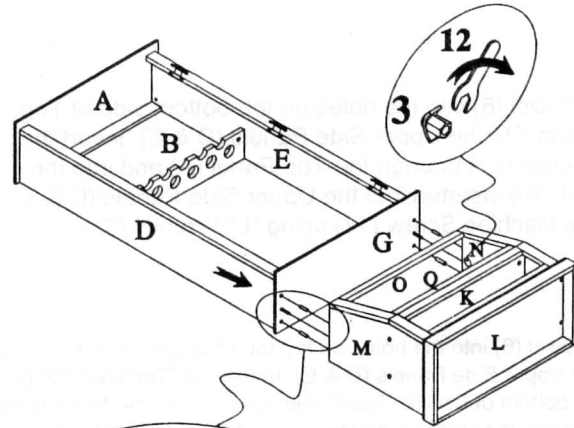

Step 9

Step 9:

Attach Upper Back Panel (C) and Bottom Back Panel (J) to the back of the assembled Upper Cabinet and Lower Cabinets using Round Head Wood Screws (4). Tighten with Philips Head Screwdriver (Not Provided).

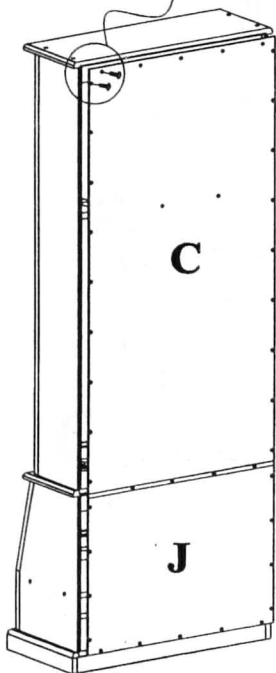
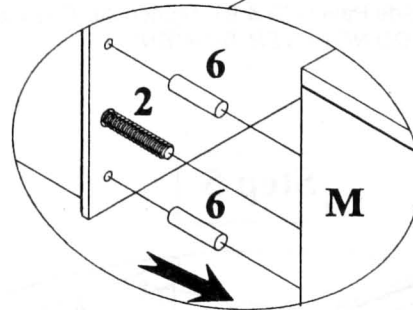

Assembly Instructions: 898 12 Gun Slanted Base Cabinet

Step 10:

Place the Gun Cabinet down on a clean, smooth surface. Place the Door Spacer Block (9) on top of Drawer Top Panel (G). Lay Upper Door Frame (F) on top of Upper Cabinet in open position as shown in Diagram. Move Upper Door Frame (F) toward the Bottom Cabinet until it contacts the Door Spacer Block (9). Insert Flat Head Hinge Screw (5) through the holes of the Pre-attached Hinges and tighten into the Upper Door Frame (F), Middle Slanted Door Frame (R) and the Bottom Door Frame with Lock (I). Connect the Bottom Right Side Panel (N) and the Middle Slanted Door Frame (R) with the Door Support (14). Screw the Flat Head Wood Screw (5) with the Philips Head Screwdriver.

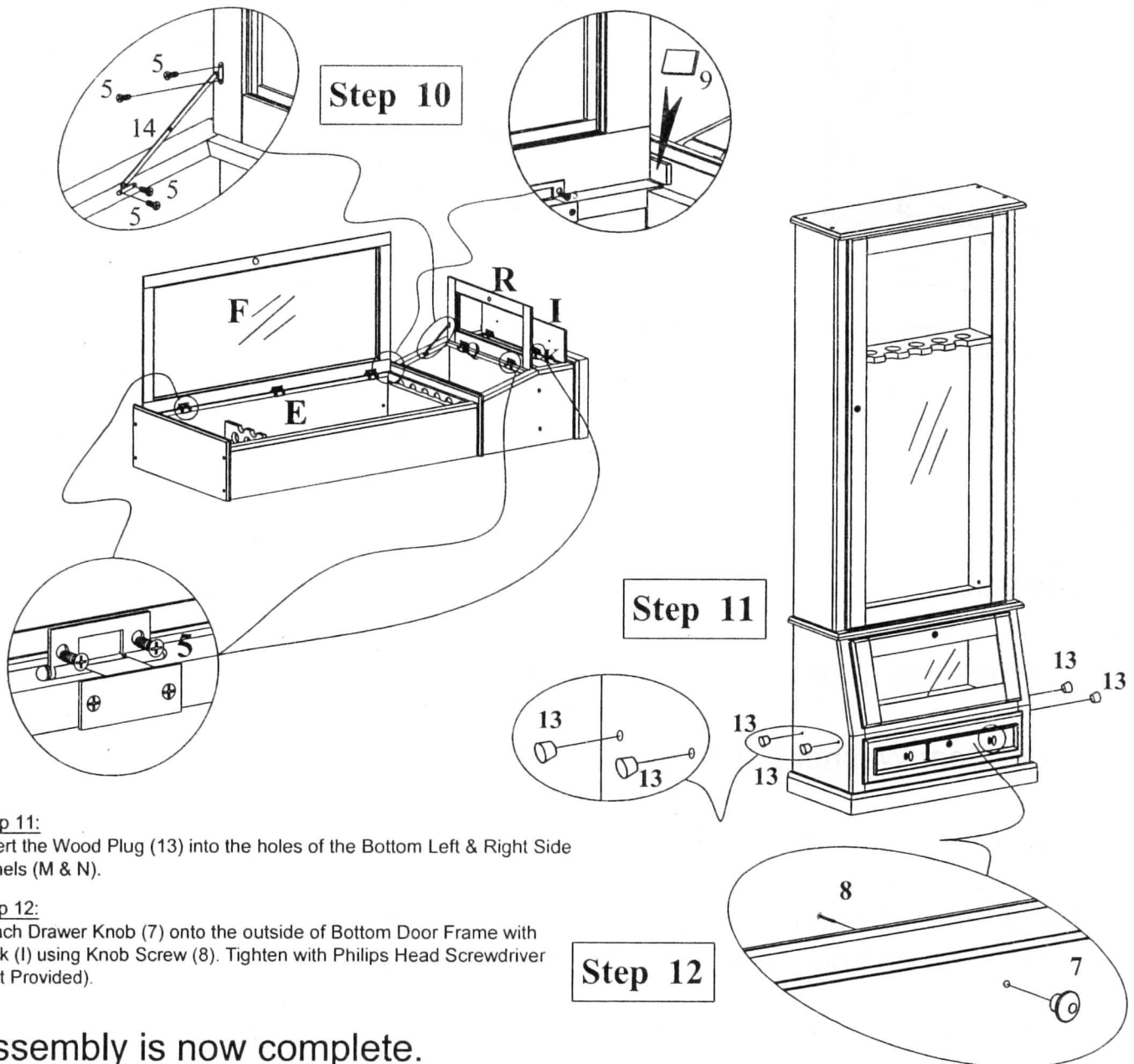

Step 11:

Insert the Wood Plug (13) into the holes of the Bottom Left & Right Side Panels (M & N).

Step 12:

Attach Drawer Knob (7) onto the outside of Bottom Door Frame with Lock (I) using Knob Screw (8). Tighten with Philips Head Screwdriver (Not Provided).

Assembly is now complete.

For extra safety we suggest you install the "Furniture Tipping Restraint" Provided in the separate hardware bag.

Post Office Box 111 - Webb City, Missouri 64870 - 0111

Toll Free - 888 - 673 - 9080

Fax - 417 - 673 - 9081

To order replacement parts online please visit:

www.AmericanFurnitureClassics.com

or E - mail:

service@americanfurnitureclassics.com

Assembly Instructions For Lock Installation

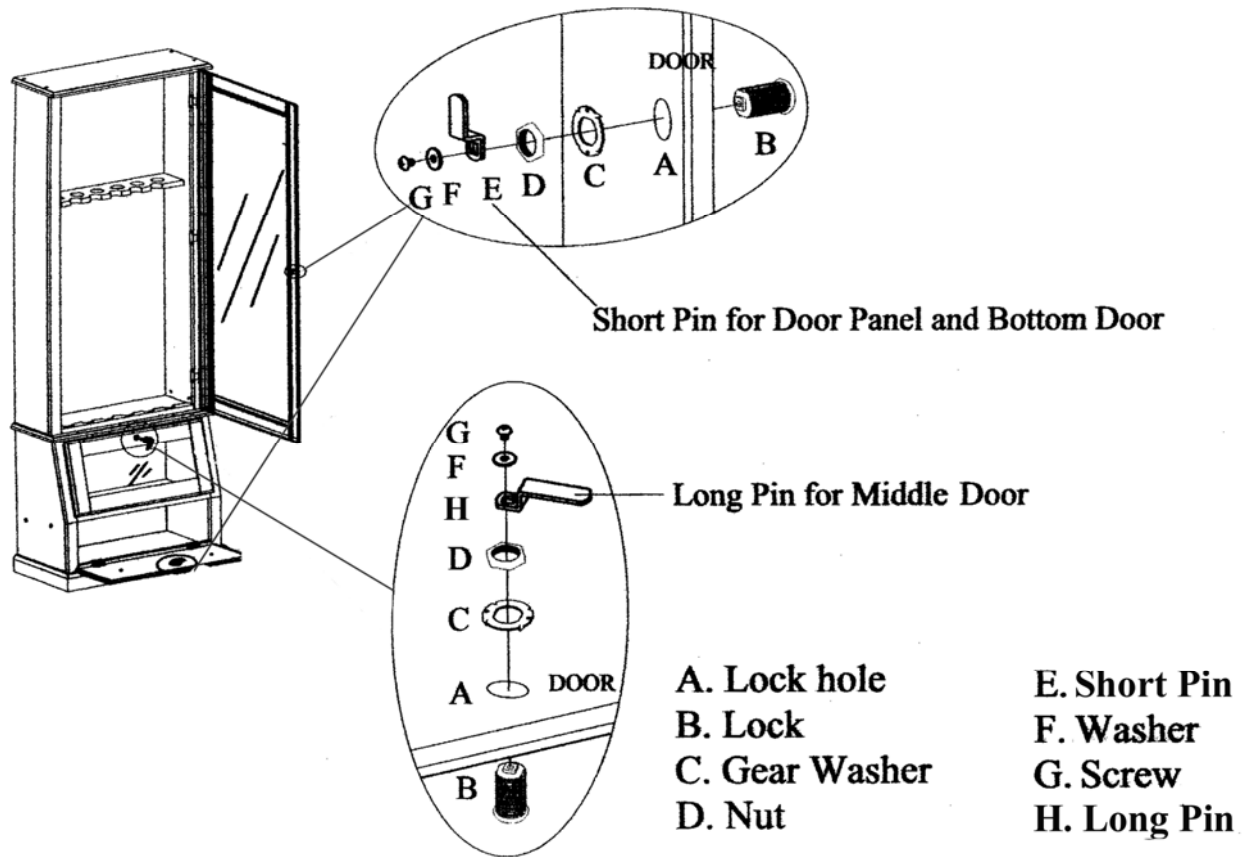

Step:

1. Insert **Lock (B)** into the **Lock Hole (A)**.
2. Put **Gear Washer (C)** on the **Lock (B)**.
3. Screw **Nut (D)** on **Lock (B)**.
4. Place **Short Pin (E)** onto **Lock (B)** for top & bottom doors. Make sure the rectangular hole on **Pin (E)** and on **Lock (B)** are aligned properly. Place **Long Pin (H)** onto **Lock (B)** for middle door and repeat process.
5. Place **Washer (F)** onto **Lock (B)** and insert **Screw (G)** into the end of **Lock (B)**.
6. Tighten or loosen **Screw (G)** until **Pin (E)** fits tightly behind the back edge of the Door Frame when door is fully closed and lock is in locked position.

LEVELER DIAGRAM

- Insert threaded section of “leveler” into holes in bottom corners of the cabinet.
- Screw all four (4) levelers completely into the Base of the Cabinet.
- When cabinet is placed in it’s final location, position it in your Room. Unscrew the levelers to adjust for any unevenness in your floor or carpeting.
- **IMPORTANT**: We suggest that you extend (unscrew) the two (2) front levelers slightly more than the two (2) rear levelers. This will tip the cabinet back at a slight angle towards the wall. This will cause the door to “automatically” swing slowly closed.

